

GUELL MICRO S/EW



Part number	3101178
Lampholder:	LED
Light Source:	LED
Wattage:	10 W
Finish:	AN-96 / Anthracite gray / Textured
Insulation class:	I
Degree of protection:	IP 66
IK-J-xxIP:	IK06 1J xx3
CRI:	80
Kelvin:	3000
Power factor:	COSφ ≥ 0,9
Optic:	SYMMETRIC EXTRA WIDE REFLECTOR
Lightsource lumen output:	1350 lm
Luminaire lumen output:	611 lm
L:	L70
B:	B10
Lifetime:	35000 h
Ta MIN luminaire:	-20°
Ta MAX luminaire:	25°



Description

- LED floodlight for indoor and outdoor lighting, comprising:
- Painted, die-cast aluminium housing, in compact size.
 - Extra-clear flat tempered glass diffuser with internal screen printing
 - Waterproof cable gland M16x1.5 for cables Ø 5- Ø 10 mm
 - Mains voltage 220-240V 50/60Hz LED module protected against surges up to 500V
 - Stainless steel external screws
 - Painted steel bracket
 - Complete with 1 metre of cable H05RN-F 3G1 mm²
 - Technopolymer peg available for anchoring to the ground

PHOTOMETRIC DATA

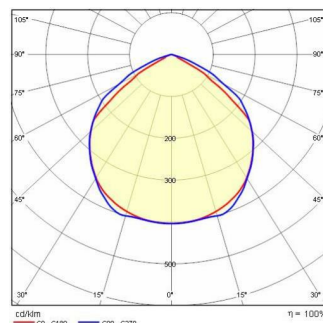

TECHNICAL DRAWINGS

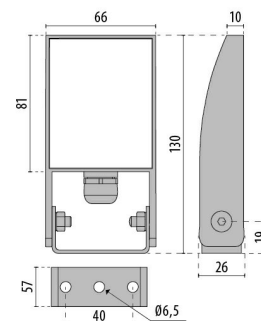

GUELL MICRO



310495
Connection Kit Y 3-way D.14-17mm
IP68



310496
Connection Kit Y 3-way D.7-10.5mm
IP68



310513
Connection Kit D.7-10.5mm IP68.



700191
Ground spike