

RA 23 S DIXIT LED

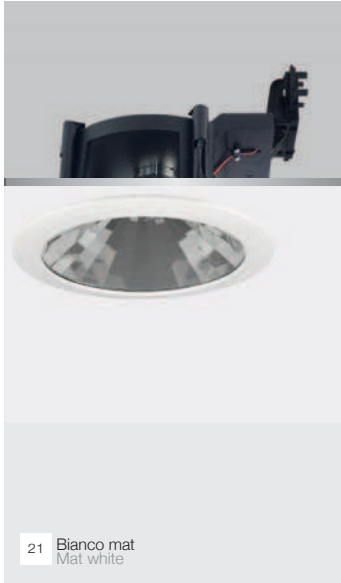

Codice Code	LED Lumen	Product Lumen	Watt	Colour T (K)	CRI	Fascio Beam
Corpo e anello in pressofusione di alluminio - Body and bezel in die-cast aluminium Schermo di chiusura in vetro temperato (4mm) - Tempered safety glass (4mm) Ottiche in termoplastico metallizzato - Optics in metallized thermoplastic material						
249-210BN	2550	2248	18	3000	85	100°
249-210AN	2600	2292	18	4000	85	100°
249-200BN	4900	4322	37	3000	85	100°
	5500	4851	43			
249-200AN	5100	4489	37	4000	85	100°
	5750	5072	43			

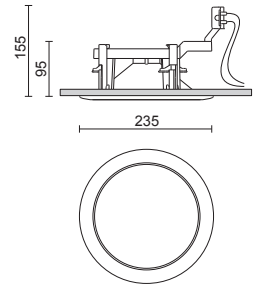

h 155mm ø 220mm 1,5kg

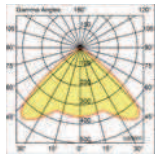

100°

CE \neq 850° IP44 IK07 A+ A+ A+

Driver da ordinare separatamente Drivers should be ordered separately		Power	Output
	81-04011	18 W	Output 500mA
	81-04013	37 W	Output 1050mA
	81-04017	43 W	Output 1200mA

RA 23 SP DIXIT LED

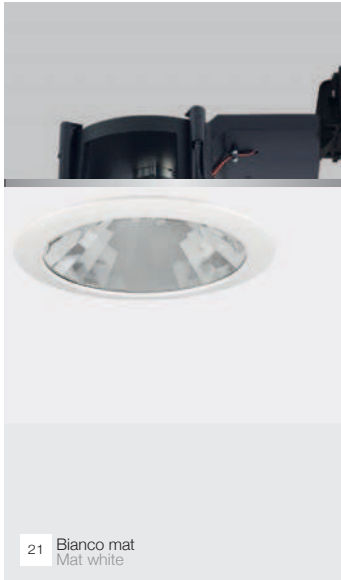

Codice Code	LED Lumen	Product Lumen	Watt	Colour T (K)	CRI	Fascio Beam
Corpo e anello in pressofusione di alluminio - Body and bezel in die-cast aluminium Schermo di chiusura in vetro temperato (4mm) - Tempered safety glass (4mm) Ottiche in termoplastico metallizzato - Optics in metallized thermoplastic material						
249-240BN	6800	5827	51	3000	85	100°
249-240AN	7000	5998	51	4000	85	100°
249-250BN	9900	9549	75	3000	85	100°
249-250AN	10200	9838	75	3000	85	100°

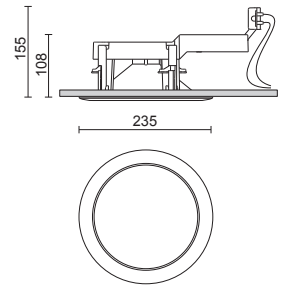

h 155mm ø 220mm 3,6kg

CE \neq 850° IP44 IK07 A+ A+ A+

Driver da ordinare separatamente Drivers should be ordered separately		Power	Output
	81-04004	51 W	Output 1400mA
	81-04018	75 W	Output 1400mA