

GUELL 3 S/W



Part number	06171694
Lampholder:	LED
Light Source:	LED
Wattage:	317 W
Finish:	GR-94 / Metallic grey / Textured
Insulation class:	I
Degree of protection:	IP 66
IK-J-xxIP:	IK07 3J xx5
CRI:	80
Kelvin:	4000
Power factor:	COS ϕ \geq 0,9
Optic:	SYMMETRIC WIDE REFLECTOR
Lightsource lumen output:	44312 lm
Luminaire lumen output:	36028 lm
L:	L70
B:	B10
Lifetime:	130000 h
Ta MIN luminaire:	-30°
Ta MAX luminaire:	35°



Description

- LED floodlight for indoor and outdoor lighting, comprising:
- Die-cast aluminium housing chemically pre-treated and painted with polyester powder coating
 - Flat extra clear tempered glass diffuser
 - Very high performance symmetrical reflector made of 99.99% plated aluminium, polished, oxidised and free of iridescence
 - Anti-ageing silicone gasket
 - Cable gland M20x1.5 for cables \varnothing 10- \varnothing 14 mm
 - Stainless steel external screws
 - Fully integrated stainless steel aluminium spring clips
 - Powder coated steel bracket
 - Dimmable ballast on request
 - 3000 K and 5000 K available upon request

PHOTOMETRIC DATA

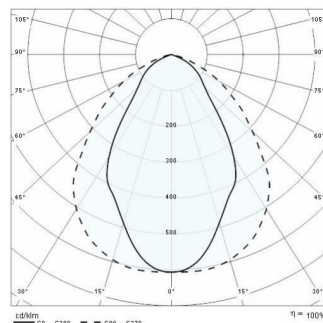

TECHNICAL DRAWINGS

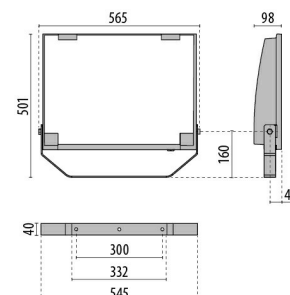

GUELL 3 A/W - S/W



14452994
Frosted glass GUELL 3 (not suitable for 158 W).

GUELL 3 S/W

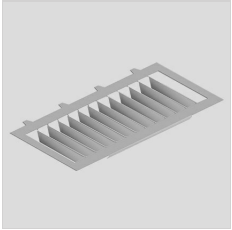

14454220
Louvre GUELL 3 Symmetrical (not suitable for 158 W).

GUELL 3



14452894
Cover

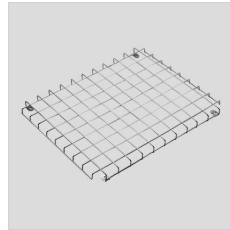

14452702
Protective grid



14453994
Wall mount support 1000 mm

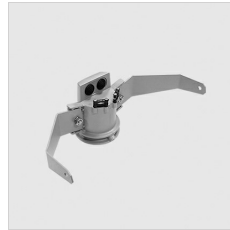

14453794
Single pole top support GUELL 3 for poles \varnothing 60-76 mm/ \varnothing 2.36"-2.99".



14453894
Double pole top support GUELL 3 for poles \varnothing 60-76 mm/ \varnothing 2.36"-2.99"

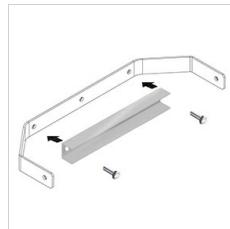

14461104
GUELL 3 strengthening bracket. Suitable for one floodlight single point fixing M10 screw in centre of the bracket.