

Family	ONE International	Description	2+2 gang
Type	Vertical	Colour	Milk white
Material	Technopolymer	Finishing	Glossy
For support codes	GW16822	Glow wire test	650 °C
Thermo-pressure with ball	70 °C	Standard	EN 60669-1
Electrocod	0110		

DIMENSIONAL

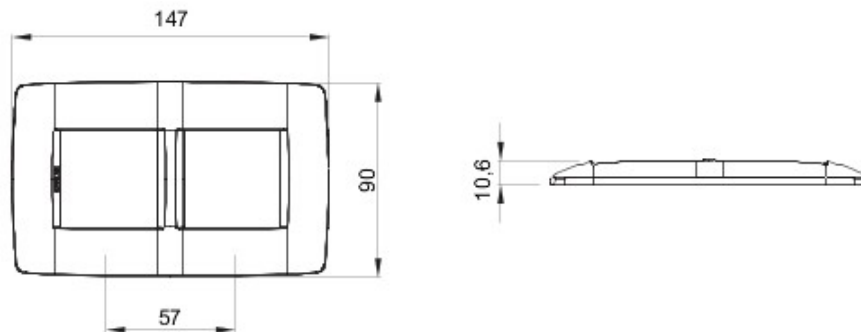

TECHNICAL SYMBOLOGY



STANDARDS/APPROVALS

